

# Dockson Model C Cutting Torch

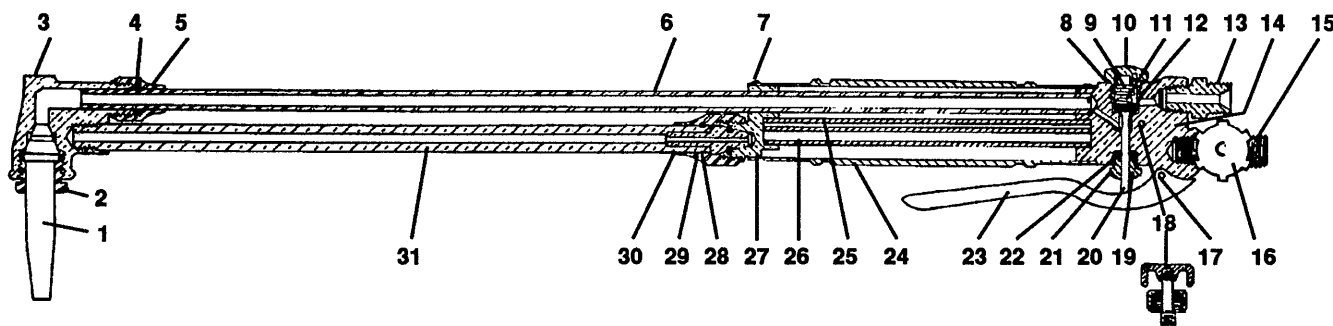

REF. NO.	MFG. NO.	S-S NO.	DESCRIPTION	CODE	REF. NO.	MFG. NO.	S-S NO.	DESCRIPTION	CODE
	C		Cutting Torch		20	98-P		Packing	
1	C		Tip		21	C-3		Pin	
2	C-1	D-080	Tip Nut		22	C-26		Gland Screw	
3	C-10A		75 Degree Head		23	C-8		Lever	
	C-10B	D-128	90 Degree Head		24	C-11		Handle	
4	C-22		Coupling Washer		25	C-16A		Oxygen L. P. Tube	
5	C-20		Coupling Nut		26	C-16B		Acetylene Tube	
6	C-14		H. P. Tube		27	C-13		Center Block	
7	L-12		Drive Screw		28	C-17A		Tube Ring	
8	C-7	D-010	H. P. Washer		29	C-21		Mixer Nut	
9	C-4		Spring		30	C-23		Mixer	
10	C-25		Plug Nut		31	C-17		Mixer Tube	
11	C-2	D-012	Seat Cup						
12	C-2B	D-002	Seat						
13	27-A		Oxygen Bushing						
14	C-24		Rear Block						
15	C-6		Valve Body						
16	58C		Valve Stem						
17	C-9		Lever Screw						
18	C-65		Valve Stem						
19	C5-75P	D-031	Packing						

# Dockson

## Model L Cutting Torch

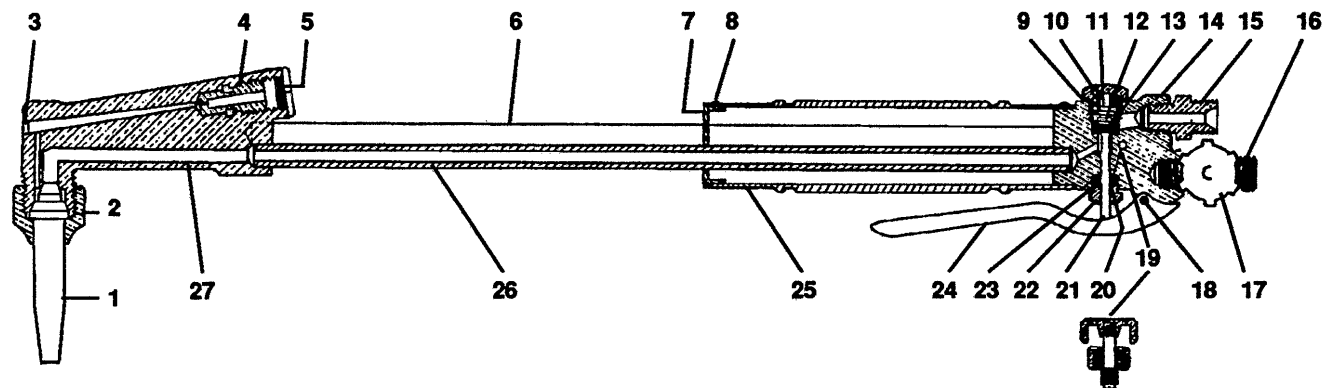

REF. NO.	MFG. NO.	S-S NO.	DESCRIPTION	CODE	REF. NO.	MFG. NO.	S-S NO.	DESCRIPTION	CODE
	L		Cutting Torch		21	C-3		Pin	
1			Tip		22	C-26		Packing Screw	
2	L-1		Tip Nut		23	C5-75P		Packing	
3	L-15		Head Plug		24	C-8		Lever	
4	L-23		Injector		25	C-11		Handle	
5	L-17		Cap		26	L-14		H. P. Tube	
6	L-16		L. P. Tube		27	L-10B	D-128	Head	
7	L-13		Center Block						
8	L-12		Handle Screw						
9	C-7		Washer						
10	C-25		Plug Nut						
11	C-4		Spring						
12	C-2		H. P. Seat						
13	C-2B	D-002	Seat						
14	L-24		Rear Block						
15	134-27A		Oxygen Bushing						
16	C-6		Valve Body						
17	58C	D-078	Valve Stem						
18	C-9		Lever Screw						
19	65C	D-082	Valve Stem						
20	98-P		Packing						

# Dockson Model CM Cutting Torch

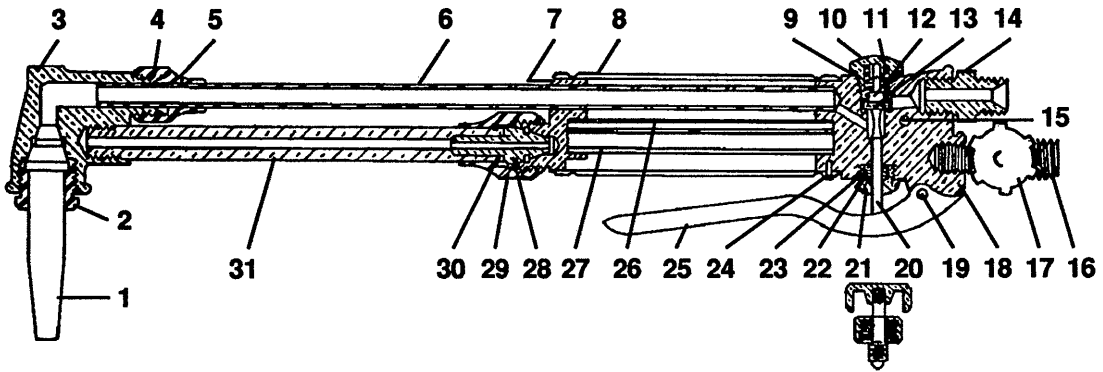

REF. NO.	MFG. NO.	S-S NO.	DESCRIPTION	CODE	REF. NO.	MFG. NO.	S-S NO.	DESCRIPTION	CODE
	CM		Cutting Torch		21	C-26		Gland Screw	
1	C		Tip		22	C5-75P	D-031	Packing	
2	C-1	D-080	Tip Nut		23	98-P		Packing	
3	C-10B	D-128	90 Degree Head		24	L-12		Drive Screw	
4	C-22		Coupling Washer		25	C-8		Lever	
5	C-20		Coupling Nut		26	CM-16A		Oxygen Tube	
6	CM-14		H. P. Tube		27	CM-16B		Acetylene Tube	
7	C-13		Center Block		28	C-23		Mixer	
8	CM-11		Handle Shell		29	C-21		Mixer Nut	
9	C-7	D-010	Washer		30	C-17A		Tube Ring	
10	C-25		Plug Nut		31	C-33		Mixer Tube	
11	C-4		Spring						
12	C-2	D-012	Seat Cup						
13	C-2B	D-002	Seat						
14	27-A		Oxygen Bushing						
15	65C	D-082	Valve Stem						
16	C-6		Valve Body						
17	58-C	D-078	Valve Stem						
18	C-24		Rear Block						
19	C-9		Lever Screw						
20	C-3		H. P. Pin						

















